

## NOTICE TO MARINERS

M115 of 2017

# KING'S REACH LOCAL TRAFFIC CONTROL HELICOPTER FILMING OPERATIONS

On Saturday 13<sup>th</sup> January 2018, Sunday 14<sup>th</sup> January 2018 and Sunday 21<sup>st</sup> January 2018 filming will take place in King's Reach from low-flying helicopters in support of a major film production. In order to accommodate these operations the following support will be in place:

### **Saturday 13<sup>th</sup> January 2018 and Sunday 14<sup>th</sup> January 2018**

Filming operations will be undertaken from one helicopter from 08:00 to 11:30 on each day between Blackfriars Road Bridge and Blackfriars Rail Bridge.

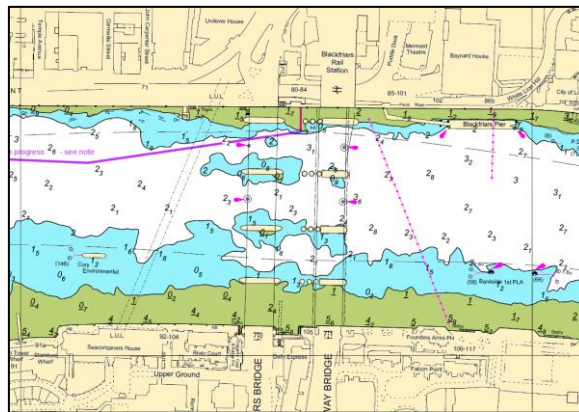

Local Traffic Control will be undertaken from two PLA Harbour Service Launches with one stationed at Bankside Pier and another downstream of Waterloo Bridge for the duration of the filming. All vessels intending to navigate between Bankside Pier and Waterloo Bridge are to call 'BLACKFRIARS CONTROL' on VHF Channel 14 as follows:

- Inbound at Bankside Pier
- Outbound at Coin Street moorings
- Prior to leaving a berth or mooring between Bankside Pier and Waterloo Bridge

All vessels are to navigate in this area with caution, maintaining a continuous watch on VHF Channel 14 and follow the instructions from the attending Harbour Service Launches exhibiting flashing blue lights. Whilst endeavours will be made to lessen the impact on river traffic at this time, operators should be aware that there may be delays to vessels of up to 10 minutes during this period.

### **Sunday 21<sup>st</sup> January 2018**

Filming operations will be undertaken from two helicopters from 08:00 to 12:00 between Waterloo Bridge and Southwark Bridge.

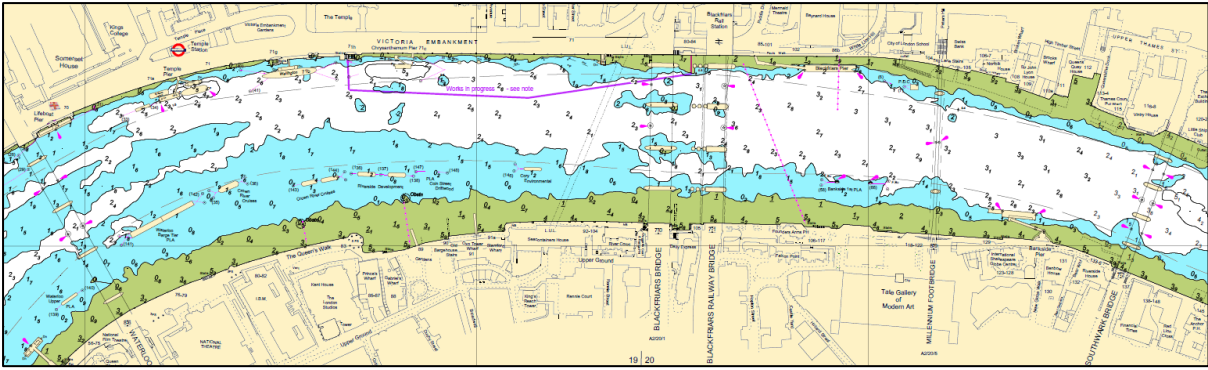

Local Traffic Control will be undertaken from two PLA Harbour Service Launches with one stationed at Bankside Pier and another downstream of Waterloo Bridge for the duration of the filming. All vessels intending to navigate between Bankside Pier and Waterloo Bridge are to call 'BLACKFRIARS CONTROL' on VHF Channel 14 as follows:

- Inbound at Bankside Pier
- Outbound at Coin Street moorings
- Prior to leaving a berth or mooring between Bankside Pier and Waterloo Bridge

All vessels are to navigate in this area with caution, maintaining a continuous watch on VHF Channel 14 and follow the instructions from the attending Harbour Service Launches exhibiting flashing blue lights. Whilst endeavours will be made to lessen the impact on river traffic at this time, operators should be aware that there may be delays to vessels of up to 10 minutes during this period.

Further details will be promulgated by **London VTS** on VHF Channel 14 during routine river broadcasts.

**21 December  
2017**

Port of London Authority  
London River House, Royal Pier Road,  
Gravesend, Kent DA12 2BG

**BOB BAKER  
CHIEF HARBOUR MASTER**



EXPIRY DATE: 23<sup>rd</sup> January 2018  
TO RECEIVE FUTURE NOTICES TO MARINERS BY **E-MAIL**,  
PLEASE REGISTER VIA OUR WEBSITE [www.pla.co.uk](http://www.pla.co.uk)  
**Telephone calls, VHF radio traffic, CCTV and radar traffic images may  
be recorded in the VTS Centres at Gravesend and Woolwich**

