



PORT OF LONDON
AUTHORITY

Port of London Authority
Chart Correction Advice
Date: 20th January, 2020



CCA No: 201820/4

Chart: Gravesend Reach (Middle)

PLA Chart No. 336

HO Ref No. 113-336-422

Previous Chart Correction: 2020/1

The accompanying block corrections show:

The removal of West Street Pier & new Tilbury 2 Jetty

West Street Pier Area

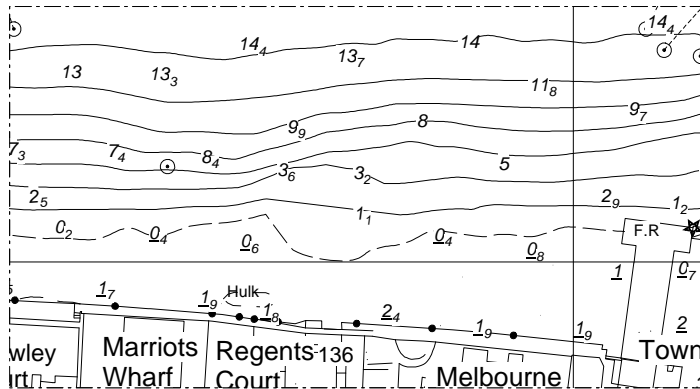

Tilbury 2

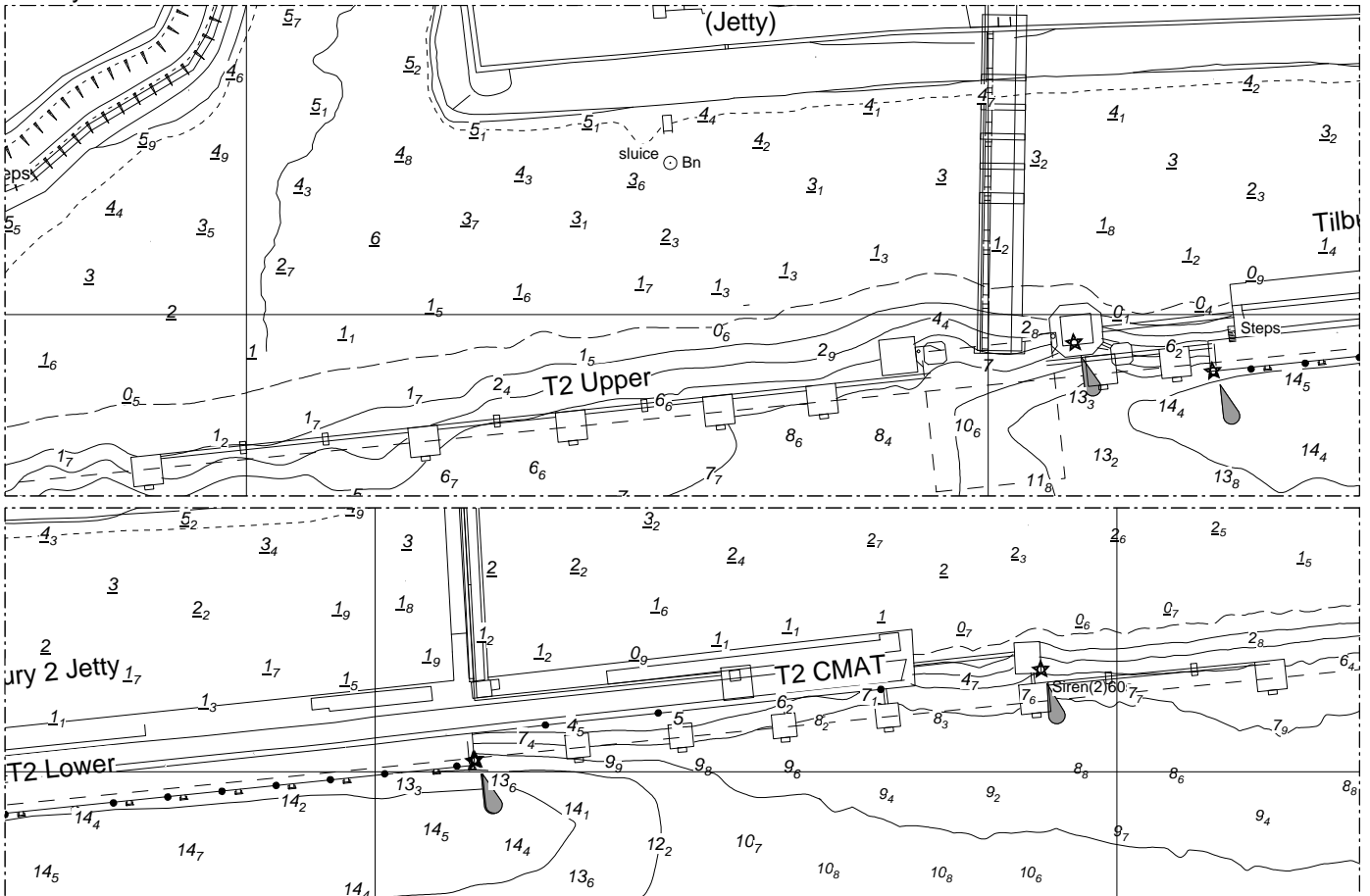

For further information see the PLA hydrographic service website:

<http://www.pla.co.uk/Safety/PLA-Hydrographic-Service-Published-Surveys>