

River Thames NORTHFLEET HOPE



THURROCK

Port of Tilbury (London) Ltd

DEPTHS in METRES

SCALE 1:2500

Surveyed by the Port of London Authority Hydrographic Service

July 2013

DEPTHS
Depths are in metres and are reduced to Chart Datum, being 3.12m and 3.20m below Ordnance Datum (Newlyn), which is approximately the level of Lowest Astronomical Tide.

HEIGHTS
Heights are in metres. Underlined figures are drying heights above Chart Datum; all other heights are above MHWS.

POSITIONS
Positions are referred to the Ordnance Survey of Great Britain (1936) Datum.

CONVERGENCE
True North is 1° 49' West of Grid North at 5615000E.

AUTHORISED CHANNEL
The pecked lines indicate the limits of the authorised channel.

DISTANCES
Distances from London Bridge are shown along the N channel edge in Sea Miles and tenths against this symbol.

ANCHORING
Anchoring is prohibited in the fairway and within 60 metres of any tunnel under the river, except in an emergency.

LADDERS
Usable ladders allowing access to from the river at certain states of the tide are shown thus.

LIGHTS ON JETTIES
Light stars without legends represent two fixed lights displayed vertically. They are seen as red to port and green to starboard when proceeding upriver.

TOPOGRAPHY
The shore features on this chart are based largely on Ordnance Survey digital map data with the permission of the Controller of Her Majesty's Stationery Office. © Crown copyright.

MOORINGS
Mooring screws are shown in their true position thus and buoys shown as symbols. Buoy numbers shown (20) are PLA references.

PLA REFERENCES
The numbers shown on the shore and in parentheses in the river adjacent to moorings refer to PLA licences.

PLA PUBLICATIONS
Refer to PLA Publications for further information:
1. PLA River Byelaws
2. General Directions for Navigation
3. PLA Tide Tables & Port Information
4. The River Thames Recreational Users Guide
5. Mariner's Guide to Bridges on the Tidal Thames

PLA HYDROGRAPHIC SERVICE WEBSITE
www.pla.co.uk/hydrohomepage

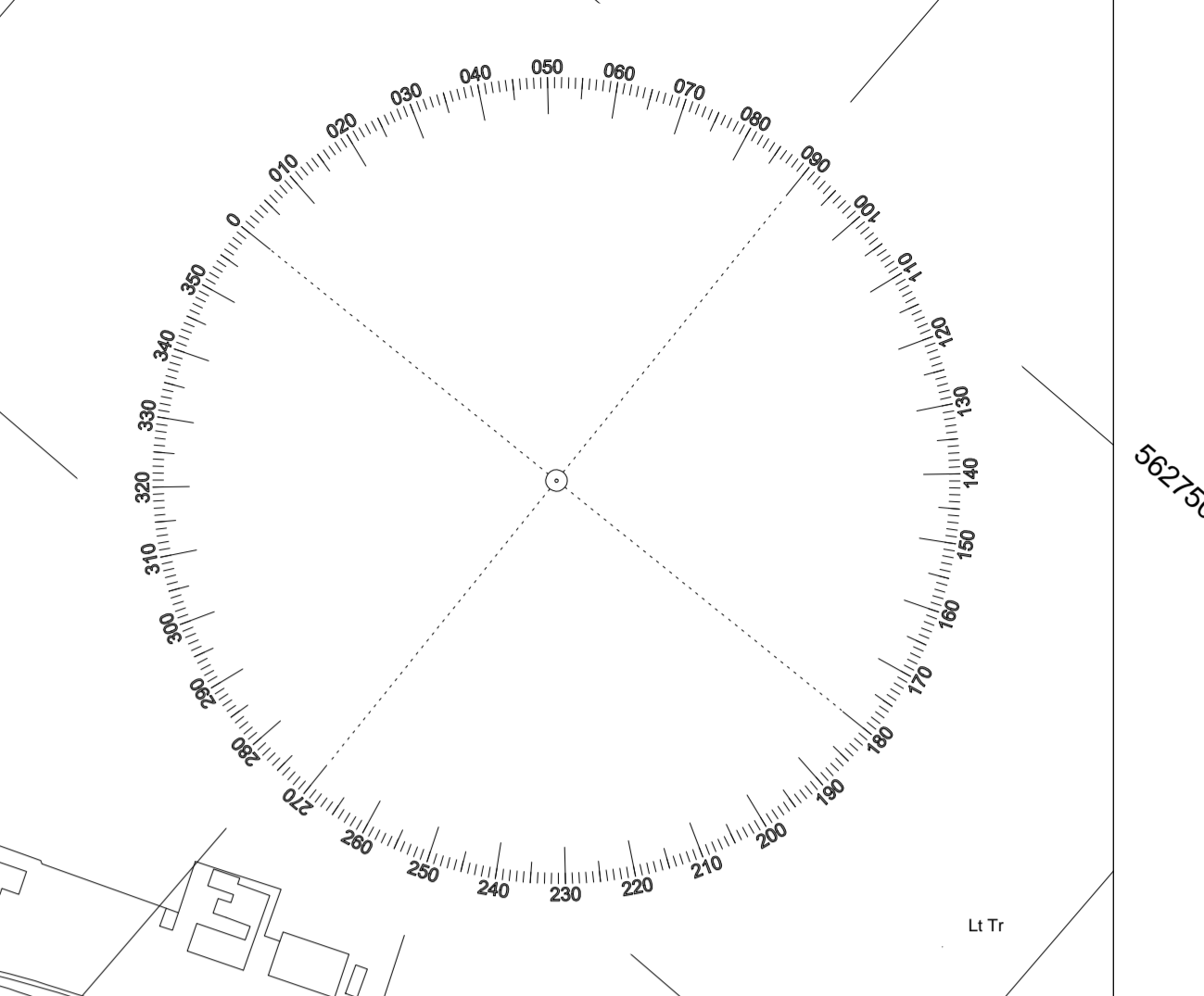
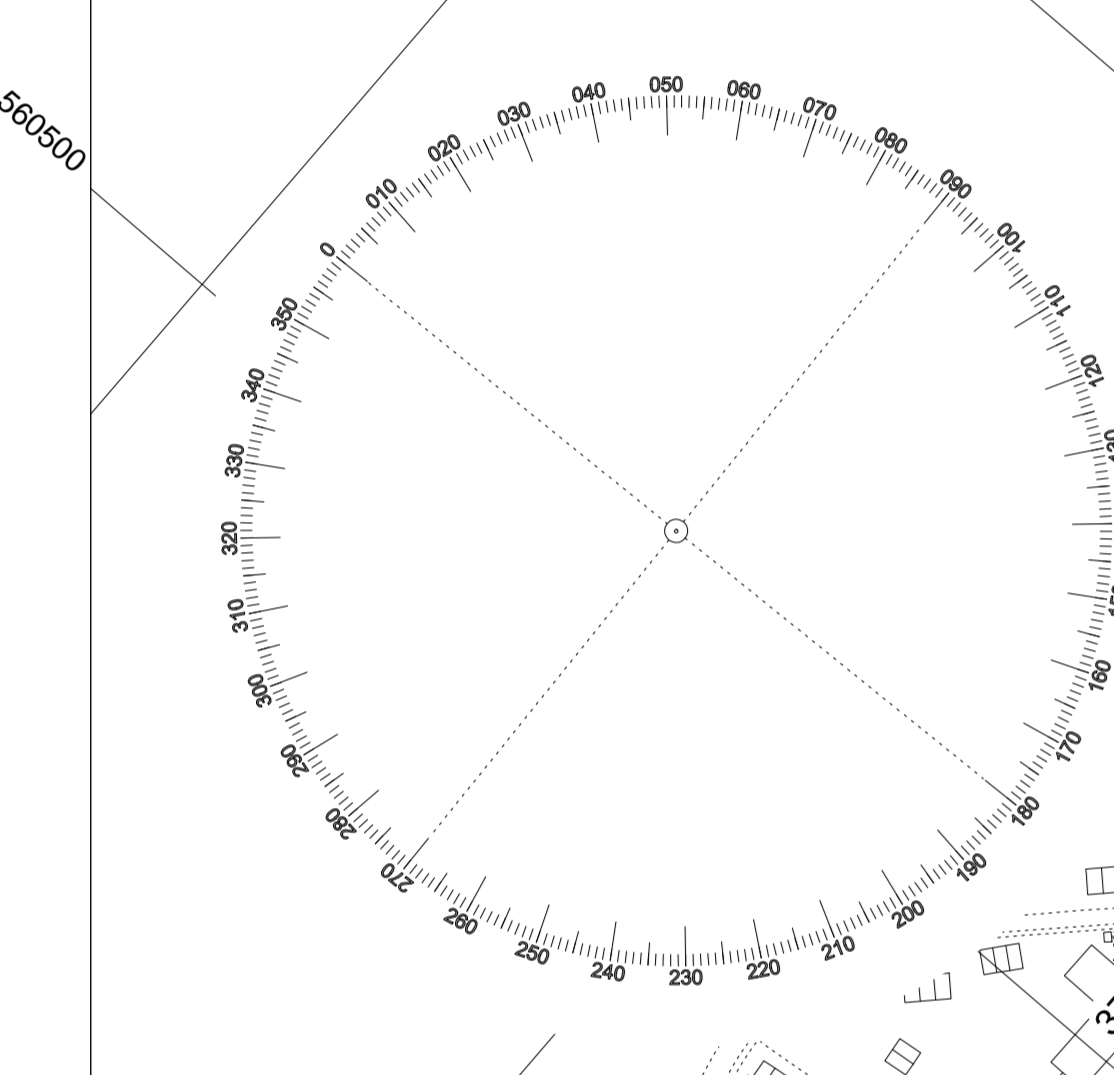

DATUM
3.20m
ODN

DATUM
3.20m
ODN

Tide Details, referred to levels at Tilbury	Ordnance Datum	Chart Datum
Highest Recorded High Water	4.92	8.04 (1953)
H.A.T.	5.93	7.05
Mean High Water Springs	3.44	6.56
Mean High Water	3.07	6.99
Mean High Water Neaps	2.29	5.41
Ordnance Datum (Newlyn)	-	3.12
Mean Low Water Neaps	-1.61	1.51
Mean Low Water Springs	-2.66	0.56
Chart Datum	-3.12	-
Lowest Recorded Low Water	-3.87	-0.75 (1987)

